

LARGE BAR WITH ZONING

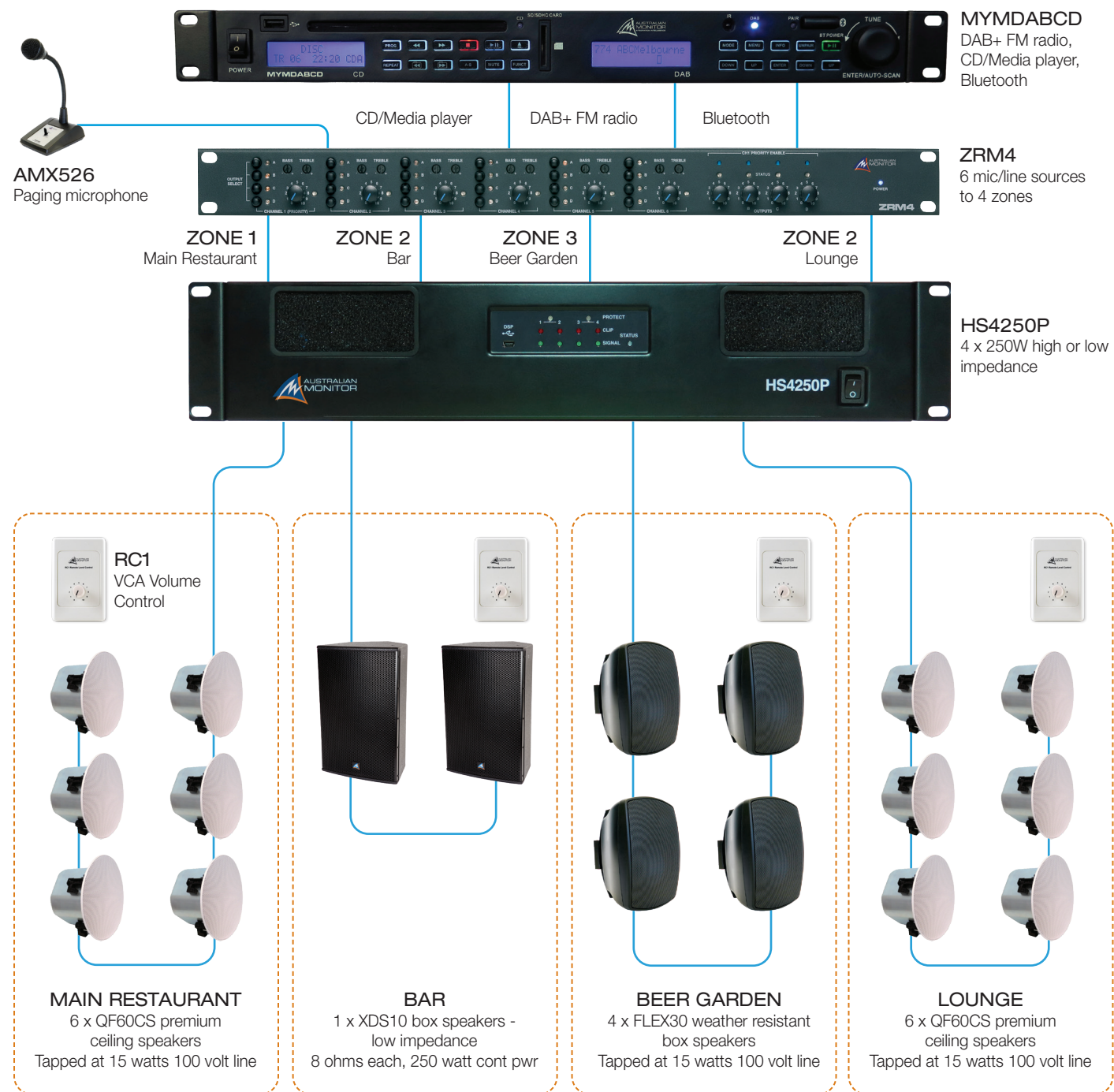

LARGE BAR WITH ZONING

- In this example an **MYMDABCD** provides BGM (Back Ground Music) program source and an **AMX526** provides paging.
- The **MYMDABCD** has discrete outputs for CD/Media, DAB+/FM Radio and Bluetooth. These can each be connected to a separate input on the **ZRM4** zone routing mixer.
- The **ZRM4** mixer allows source music from the **MYMDABCD** and local announcements from the **AMX526** paging mic to be routed to any or all of the four zones.
- From the front of the **ZRM4** each of the 6 inputs can be routed to each of the 4 zones.
- With the **AMX526** connected input 1 the paging microphone can be set to all zones or excluded from any zone if desired.
- Alternatively, paging priority can be assigned to each zone giving the **AMX526** priority over all other inputs.
- Local RC1 VCA volume controls allow the master level in each zone to be controlled separately
- Amplification is provided by the **HS4250P** 4 x 250-watt power amplifier. Each of the 4 outputs can be configured for either 100-volt line or low impedance loads.
- For speakers used in this example:
 - **QF Series** premium coaxial speakers in the main Restaurant zone are connected in 100v line configuration.
 - High powered XDS series box speakers in the Bar area. These speakers are connected to the low impedance connections on the **HS4250P** using the pass through connection on the speakers.
 - **FLEX30** weather resistant speakers in the outdoor Beer Garden, connected in 100-volt line configuration.
 - **QF Series** premium ceiling speakers in the Lounge area are also connected 100-volt line configuration.